

In case of large radial runout **FDI®-scraper model YS** is recommended.

The radial dynamic movement/contact will be at the top axial lip sections, which are in contact with the housing (or cover plates).

Axial movement of the shaft is allowed at the same time.

For large axial movement **model Y-SG** is recommended. The radial runout is limited acc. indicated gap C between shaft and housing. For larger runout special designs are available on request.

spring: stainless steel

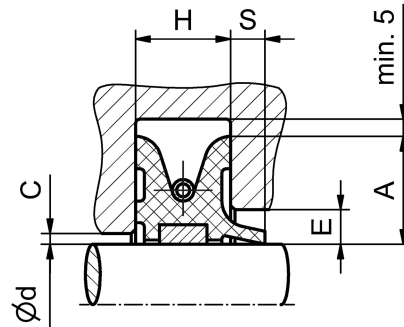

media to be sealed: oil, grease, water, slurry, suspension with hard particles

model		radial runout
		mm max.
<b>Y-SG</b>	<b>endless</b>	Pls. see „C“

Split version possible.

material:	temperature °C		chemical resistance
	min.	max.	
<b>FDI® 1004</b>	-40	+120	as NBR
<b>FDI® 2004</b>	-40	+170	as HNBR
<b>FDI® 3004</b>	-30	+200	as FPM

Ø range of d (mm) f8	cross section			C	E min.	S
	radial height A	width Tol.				
		H	+ / -			
< 50	11	10	± 0,1	2	6	5
50 - 100	16	12,5	± 0,1	3	7	6
100 - 250	20	16	± 0,1	3	7	6
250 - 400	22	20	± 0,1	4	9	8
400 - 600	25	22	± 0,2	4	10	8
> 600	32	25	± 0,2	5	11	9

Indicated sizes are dimensions of housing!

except "A" = height of profile!

To allow radial movement of the seal: A + max. 5 mm.  
(according radial runout)

Running surface:	hardness min.	Roughness max.
	HRc	Ra
- axial surface	30	0,4
- Ø shaft	30	0,4

**Size list:**

<b>Ø d f8</b>	<b>Ø D (scraper)</b>	<b>H</b>	<b>A</b>	<b>S</b>
<b>(mm)</b>	<b>(mm)</b>	<b>(mm)</b>	<b>(mm)</b>	<b>(mm)</b>
140	180	16	20	6
160	200	16	20	6
170	210	16	20	6
180	220	16	20	6
200	240	16	20	6
220	260	16	20	6
250	290	16	20	6
270	314	20	22	8
285	346	16	30,5	6
300	344	20	22	8
350	394	20	22	8
375	415	16	20	6
500	550	22	25	8
560	610	22	25	8
1000	1064	25	32	9
1270	1416	28	73	10
1350	1414	25	32	9
1700	1764	25	32	9

Other sizes on request.

The data shown above is based on long lasting experience in the manufacturing and use of sealing elements. As there are many unknown possible parameters and conditions in practice, which may limit standard performance, it is requested that the user runs practical tests. Except as expressly stated, Friedrich's liability, expressed or implied, is limited to the published selling price of our defective item.

**FDI<sup>®</sup>** and **FDI-DICHTUNGEN<sup>®</sup>** are registered trademarks of Friedrich GmbH.